

6130(F) Series

Mortise Exit Device

Installation Instructions

ACCENTRA

ASSA ABLOY

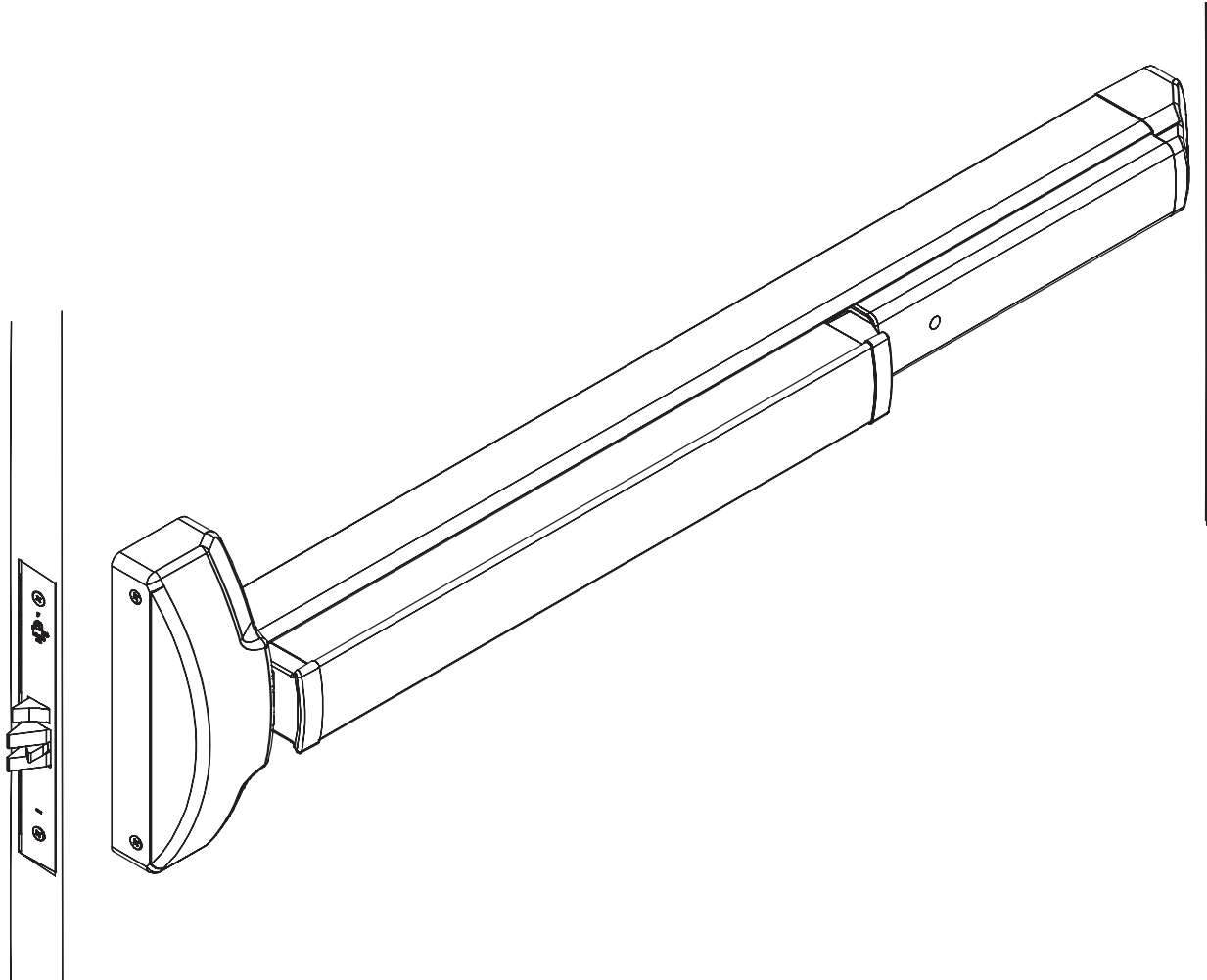

NOTE: These instructions cover standard, reinforced metal doors only. To install options, such as shim kits or interlock brackets, refer to the instructions packed with the optional component. Optional hardware is required for unreinforced metal, composite and wood doors. Device is ready for any applicable ASSA ABLOY ACCENTRA™ trim.

WARNING

This product can expose you to lead which is known to the state of California to cause cancer and birth defects or other reproductive harm. For more information go to www.P65warnings.ca.gov.

WARNING

Attention Installer: Any retrofit or other field modification to a fire rated opening can potentially impact the fire rating of the opening, and ASSA ABLOY makes no representations or warranties concerning what such impact may be in any specific situation. When retrofitting any portion of an existing fire-rated opening, or specifying and installing a new fire-rated opening, please consult with a code specialist or local code official (Authority Having Jurisdiction) to ensure compliance with all applicable codes and ratings.

80-9460-6004-000 04/24

1-855-557-5078 Ext. 2 • www.accentra-assaabloy.com

Copyright © 2015, 2023, 2024, ASSA ABLOY ACCENTRA™ Access and Egress Hardware Group, Inc. All rights reserved. Reproduction in whole or in part without the express written permission of ASSA ABLOY Access and Egress Hardware Group, Inc. is prohibited.

Experience a safer
and more open world

Table of Contents

A. Verify Parts and Templates	3
B. Exploded View.	4
C. Before Installation	5
D. Check Mortise Lock Handing	5
E. Door Reference Lines	6
F. Prepare Door and Frame with Templates	6
G. Install Lockbody (Mortise)	8
H. Install Strike Plate	9
I. Sizing Touch Bar Exit Device.	10
J. Install Device Assembly	11
K. Install Rear Clamp and End Cap	12
L. Device Assembly Cover Installation	13
M. Operation and Maintenance	14

6130(F) Series

Mortise Exit Device

Installation Instructions

ACCENTRA

ASSA ABLOY

A. Verify Parts and Templates

1. Unpack and verify components received using the parts list and exploded view.
2. Read entire instructions before installing this device.

Important:

- Verify device is being installed on the correct door, as well as function, finish, and size.
 - Use site survey to verify correct product ordered.
 - This device is intended to be installed on new 24" (610mm) to 48" (1220mm) metal or wood, pre-drilled, free swinging doors only.
3. Follow all cautions, notes and warnings presented in these instructions.
 4. All dimensions listed are in inches (") and millimeters (mm).

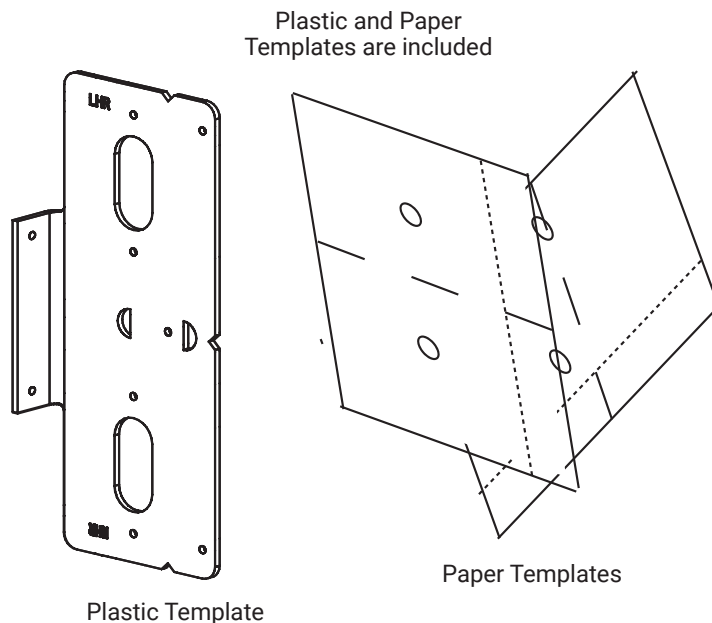

Tools Required

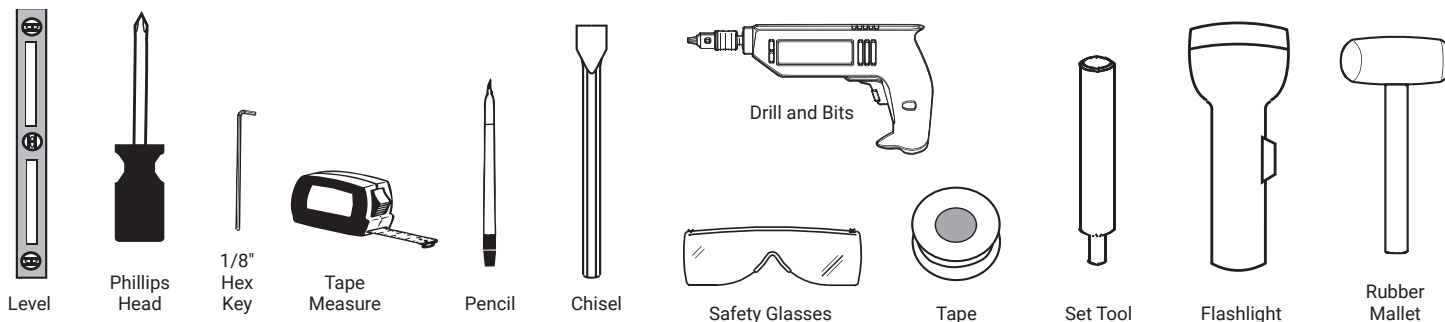

B. Exploded View

Figure 1:
Exploded View
of 6130(F)

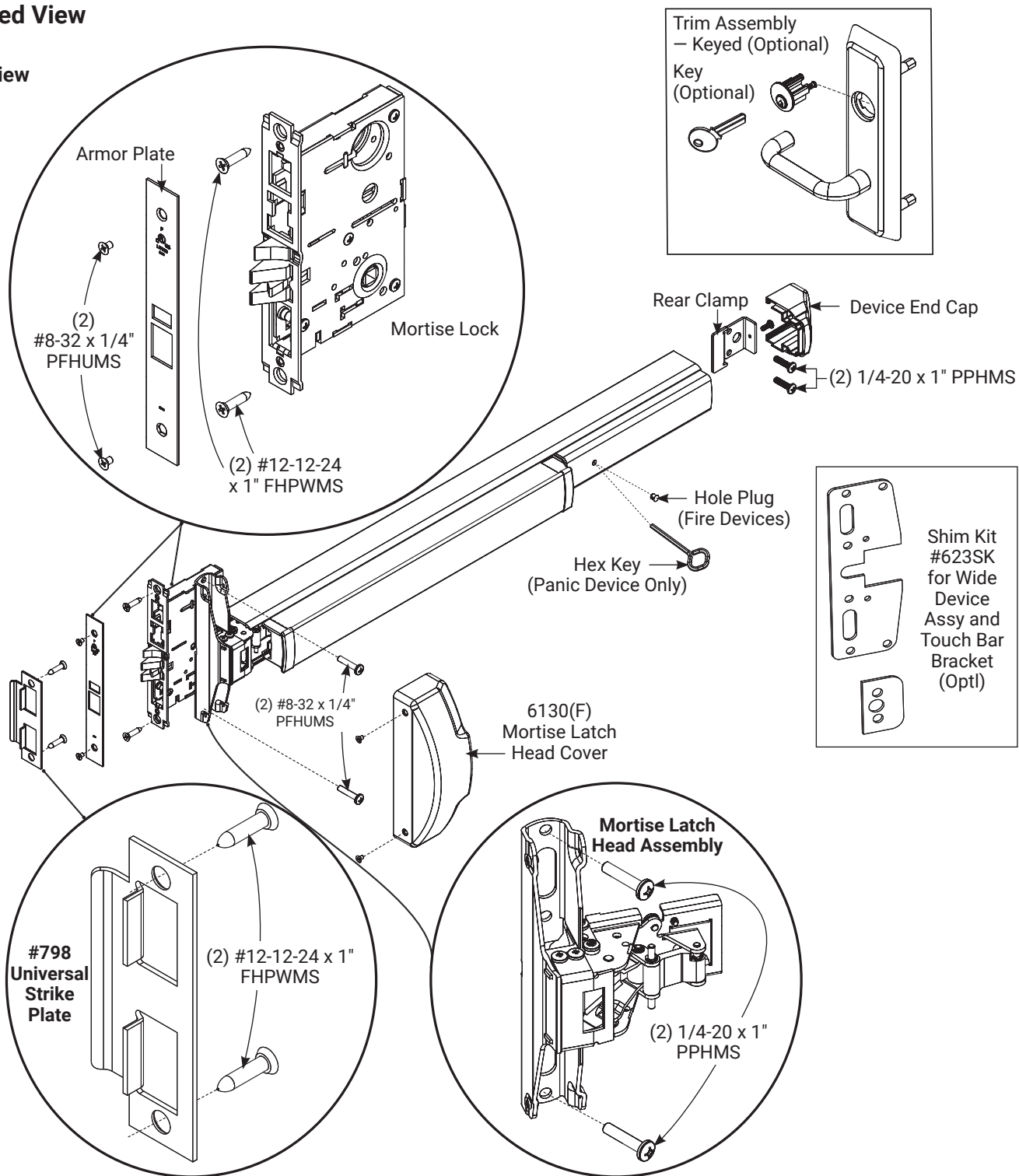

6130(F) Series

Mortise Exit Device

Installation Instructions

ACCENTRA

ASSA ABLOY

C. Before Installation

1. Make sure the door is plumb and level. Check that the hinges are secure and not missing hardware (see **Figure 2**).
2. If surface of the door is free of raised projections, device may be installed without a shim kit. One (1) shim kit is needed for each 1/4" of projection:
 - 6130(F) - 623SK

3. Fully open the doors to ensure doors do not hit floor as they swing.
4. Determine if door is reinforced. Door and frame thickness must have three (3) full screw threads to be considered reinforced.

Important:

- For unreinforced doors use SNBs (Sex Nuts and Bolts).
- For unreinforced frames use Blind Rivet Nuts.

Figure 2: Installation Check

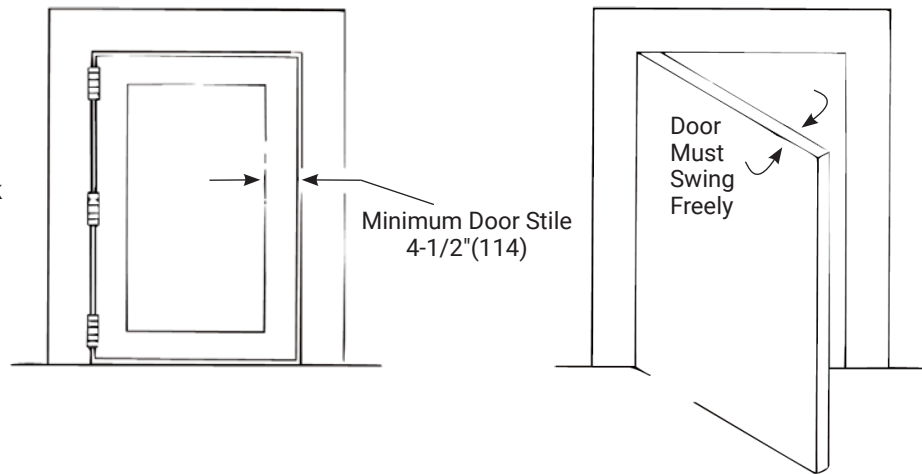

D. Check Mortise Lock Handing

1. To change lock handing, remove screws on lockbody, open cover and remove flip/latchbolt and guardbolt (see **Figure 3**).

Figure 3: Mortise Lockbody with Cover Removed

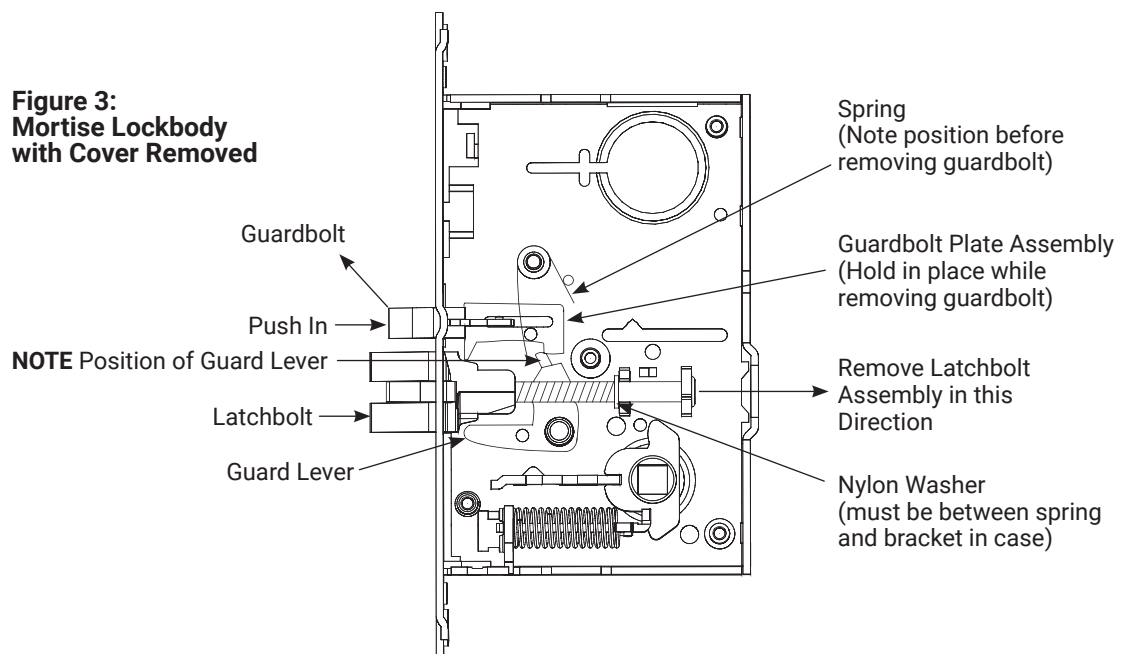

80-9460-6004-000 04/24

1-855-557-5078 Ext. 2 • www.accentra-assaabloy.com

Copyright © 2015, 2023, 2024, ASSA ABLOY ACCENTRA™ Access and Egress Hardware Group, Inc. All rights reserved. Reproduction in whole or in part without the express written permission of ASSA ABLOY Access and Egress Hardware Group, Inc. is prohibited.

Experience a safer
and more open world

E. Door Reference Lines

1. Backset is measured from centerline of bevel which is centerpoint of door thickness (**Figure 4a**).
2. Locate and mark horizontal centerline and vertical centerline as shown.

NOTES:

- Standard rail centerline height is 39-15/16" (1015mm) above finished floor.
- Centerline of lock must match Horizontal Reference Centerline.

F. Prepare Door and Frame with Templates

Prepare the door and frame with templates (**Figure 4a**).

NOTE: If factory prepared cutouts with field drilled mounting holes are in the door, skip to "G. Install Lockbody (Mortise)" on page 8. If the door (lock) and frame (strike) need to be mortised in the field, continue with Step F instructions.

Figure 4a: Prepare Door and Frame with Templates

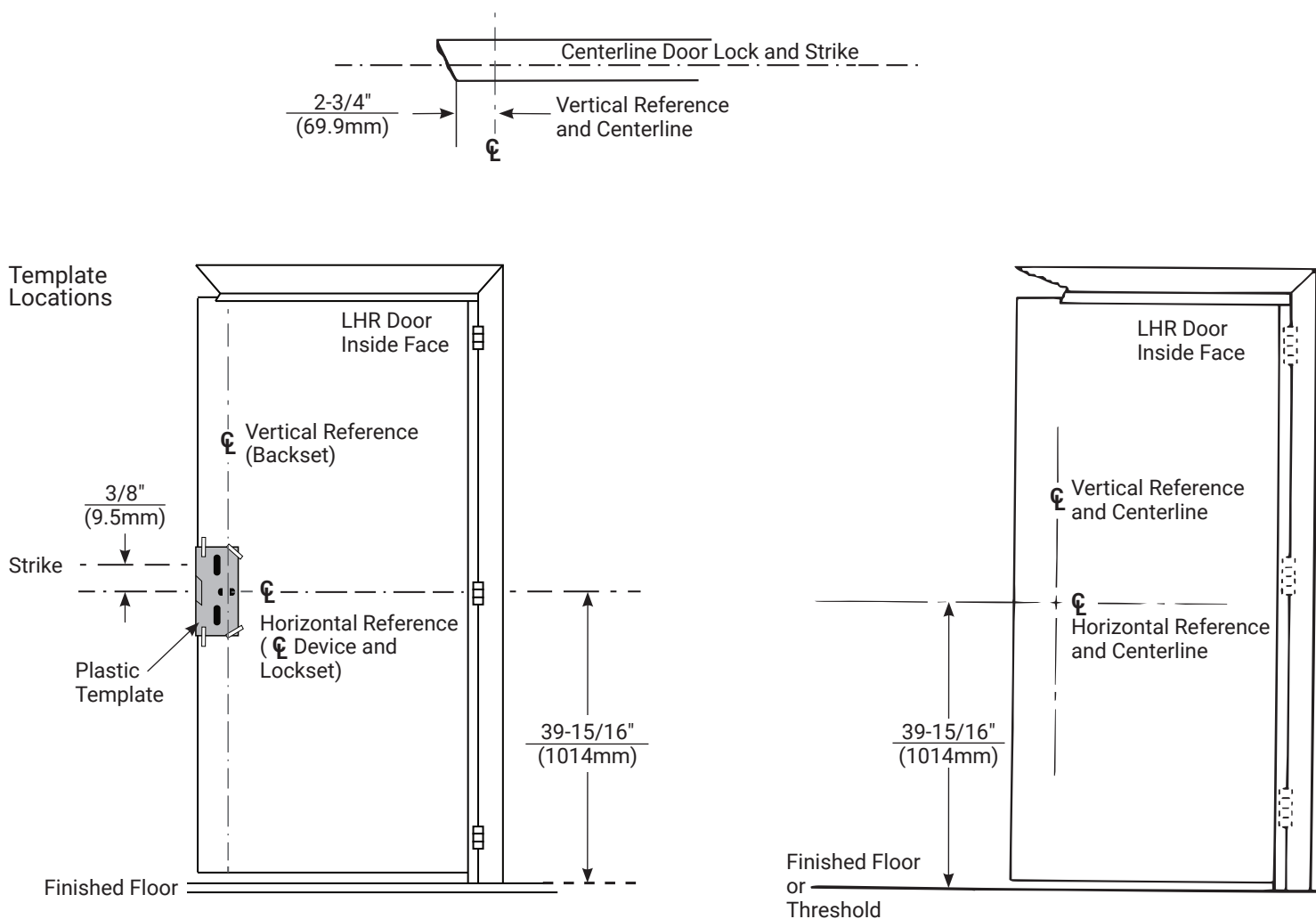

6130(F) Series

Mortise Exit Device

Installation Instructions

Plastic Template

Prepare mounting holes as follows:

1. Use plastic template provided and position on door and frame. Align vertical and horizontal reference centerlines on door with notches on template (see **Figure 4b**).
2. Tape template to door face. Mark door per template.
3. If trim is used, locate templates packed with trim. Position templates and mark holes per trim instructions.
4. Drill and tap only those holes needed for the device being installed (see **Table 1**).
5. Ensure that the latch assembly lever hole is predrilled to accommodate latch lever.
6. Check by inserting lock into door, adjust front for door edge (beveled or flat, see "D. Check Mortise Lock Handing" on page 5).

Figure 4b: Prepare Door and Frame with Templates

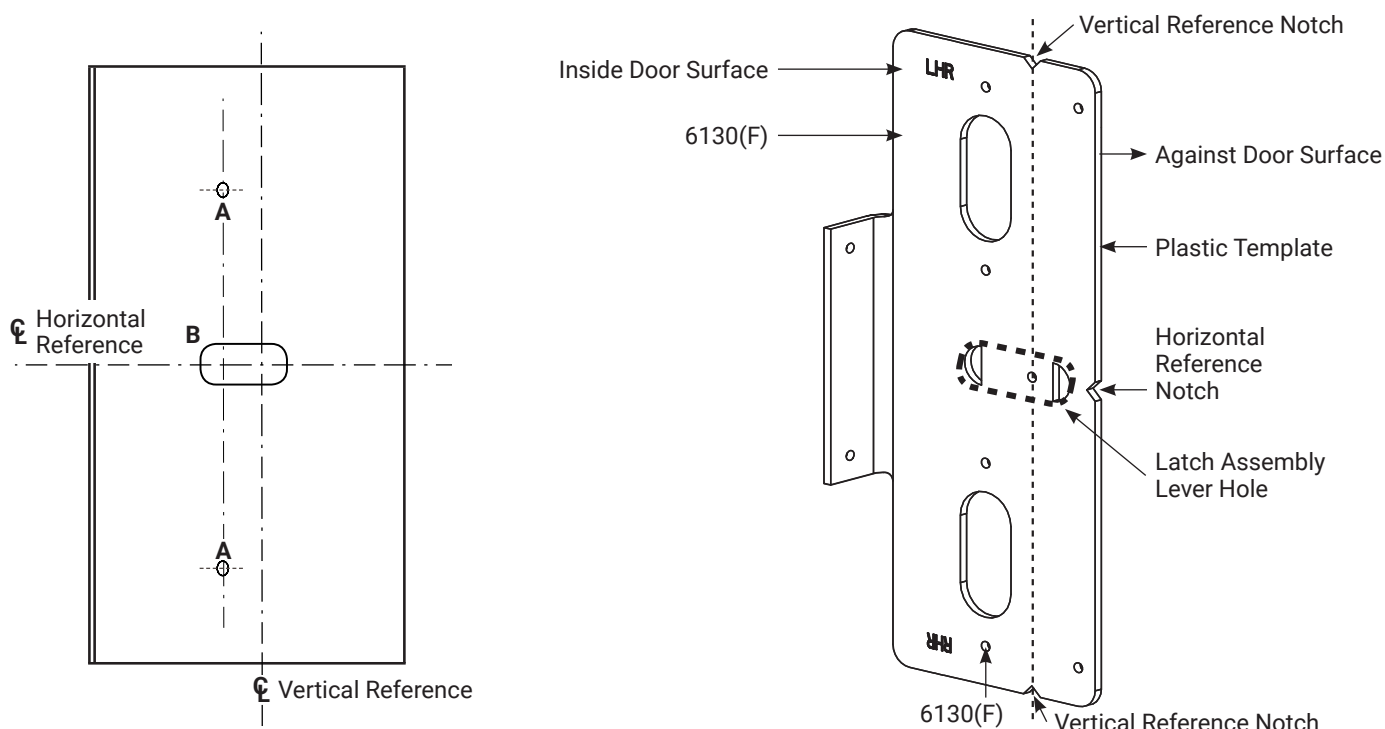

Table 1: Door and Frame Preparation

Hole	Door/Frame	Fastener	Preparation
A	Metal Reinforced	1/4-20 PPHMS	Drill: #7(Ø 0.201") Tap: 1/4-20
	All Others	1/4-20 SNB	Drill: Ø 3/8" thru
B	All	—	OB 1/2" x 1-9/16"

G. Install Lockbody (Mortise)

1. With lockbody in door cavity, fasten to door edge with two (2) 12-12-24" FHPWMS. Leaving screws loose two (2) full turns (**Figure 5**).
2. Check that latchbolt and deadbolt (optional) retract and extend freely.

Figure 5: Install Lockbody (Mortise)

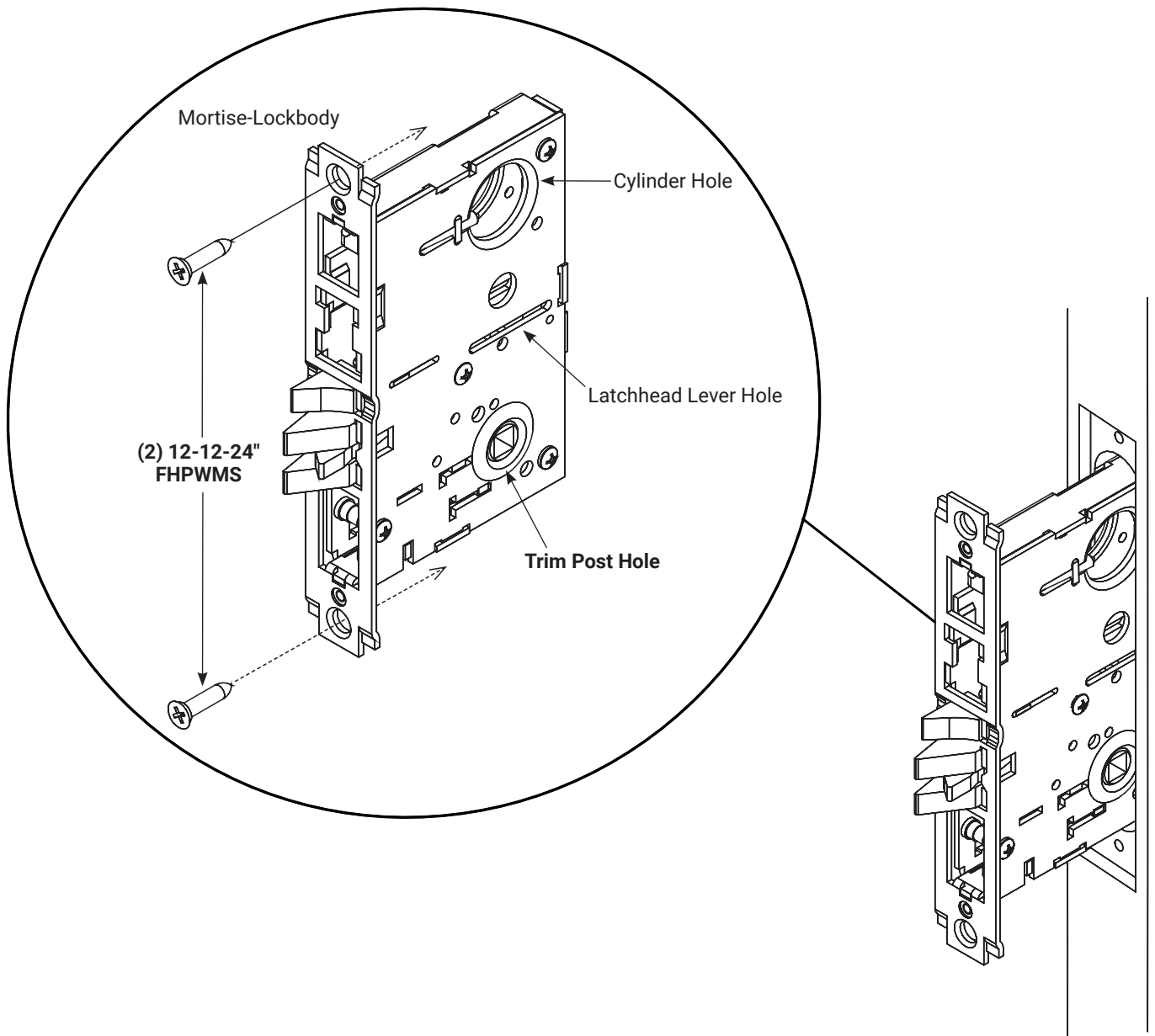

6130(F) Series

Mortise Exit Device

Installation Instructions

ACCENTRA

ASSA ABLOY

H. Install Strike Plate

1. Locate strike by marking horizontal centerline of the device onto frame (see template).

NOTE: Strike centerline is $\frac{3}{8}$ " (9.5mm) higher than device centerline (**Figure 6a**).

2. Fasten the strike securely with two (2) #12-12-24 x 1" (25.4mm) FHPWMS (**Figure 6b**).

3. Close door and check bolt engagement onto strike.

- a. Bolt should retract to clear strike when device assembly lever is depressed.
- b. Bolt should re-engage the strike when device assembly lever is released and door is shut.
- c. Door should remain latched and should not rattle when pushed, pulled or shaken.

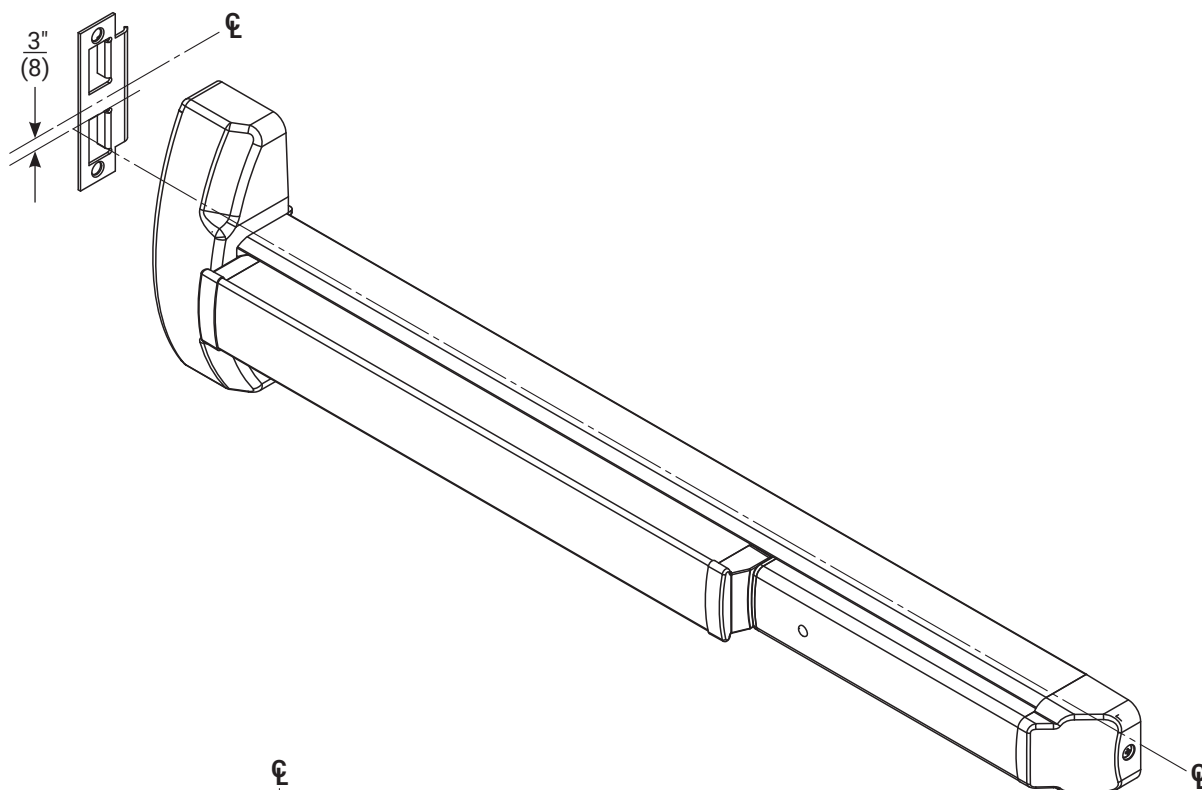

Figure 6a:
Strikeplate and Device
Assembly Alignment
(Door not Shown)

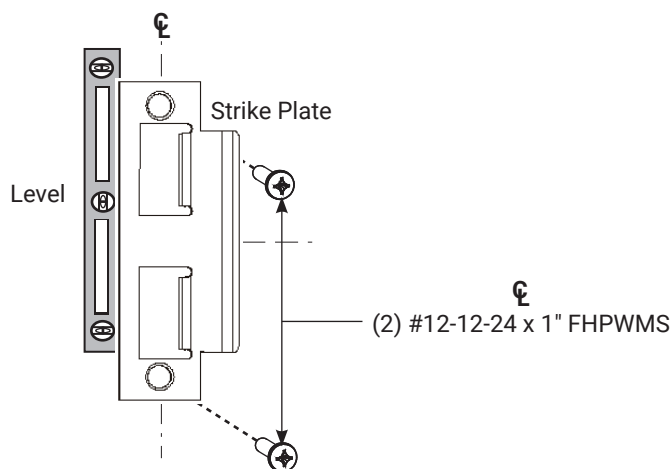

Figure 6b:
Strikeplate and Device
Assembly Alignment

80-9460-6004-000 04/24

1-855-557-5078 Ext. 2 • www.accentra-assaabloy.com

Copyright © 2015, 2023, 2024, ASSA ABLOY ACCENTRA™ Access and Egress Hardware Group, Inc. All rights reserved. Reproduction in whole or in part without the express written permission of ASSA ABLOY Access and Egress Hardware Group, Inc. is prohibited.

Experience a safer
and more open world

I. Sizing Touch Bar Exit Device

1. Bar must be cut to size if gap between bar and stop surface is less than 2-7/8" (**Table 2**).
2. With door closed, measure 2-7/8"(73mm) from stop surface on hinge side of door. Mark vertical reference line on door (see **Figure 7**).
3. Open door. Align mounting holes in latch head with mounting holes in the door. Mark device where it crosses the mark from step 2.
NOTE: For devices with dogging, hole must be at least 1-5/8" (41.3mm) from edge of bar.
4. Before cutting, ensure end cover is in place and there is no gap between the cover and the touch bar. Cut touch bar on mark from step 3.

Table 2: Standard Device Sizing

Catalog Size	Door Width		Precut Lengths	
	Minimum	Maximum	Narrow	Wide
24	24" (610)	24" (610)	—	18.426" (468mm)
36	30" (762)	36" (915)	32.196" (818)	30.426" (773mm)
42	37" (940)	42" (1067)	38.196" (970)	36.426" (925mm)
48	43" (1092)	48" (1920)	44.156" (1122)	42.036" (1068mm)

Figure 7: Sizing Touch Bar Exit Device

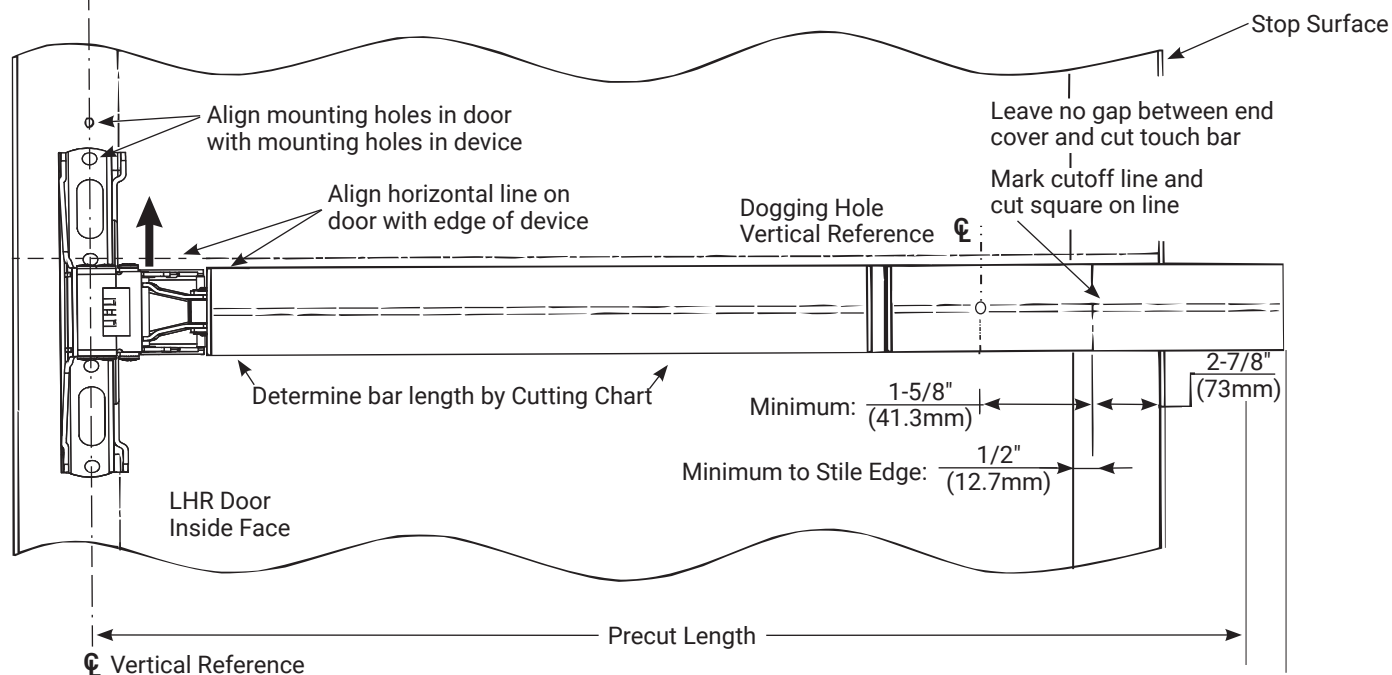

6130(F) Series

Mortise Exit Device

Installation Instructions

ACCENTRA

ASSA ABLOY

J. Install Device Assembly

Important: First determine if shim kit is needed for door face (see "C. Before Installation" on page 5).

1. Mount trim following instructions packed with trim (optional).
NOTE: If installing a cylinder, it may be necessary to leave the two (2) mortise lock screws (see "G. Install Lockbody (Mortise)" on page 8)) loose and the lockbody tipped toward the cylinder side of the door. After installing the cylinder, tighten the lock mounting screws.
2. Seat lever from back of device assembly into slot in lockbody (**Figure 8a**).
3. Ensure lever engages latchbolt.
4. Loosely attach device assembly to door using two (2) 1/4-20 x 1" (25.4mm) PRHMS (**Figure 8b**).
5. Level device and partially tighten screws (**Figure 8c**).

Figure 8a: Install Device Assembly (Door not Shown)

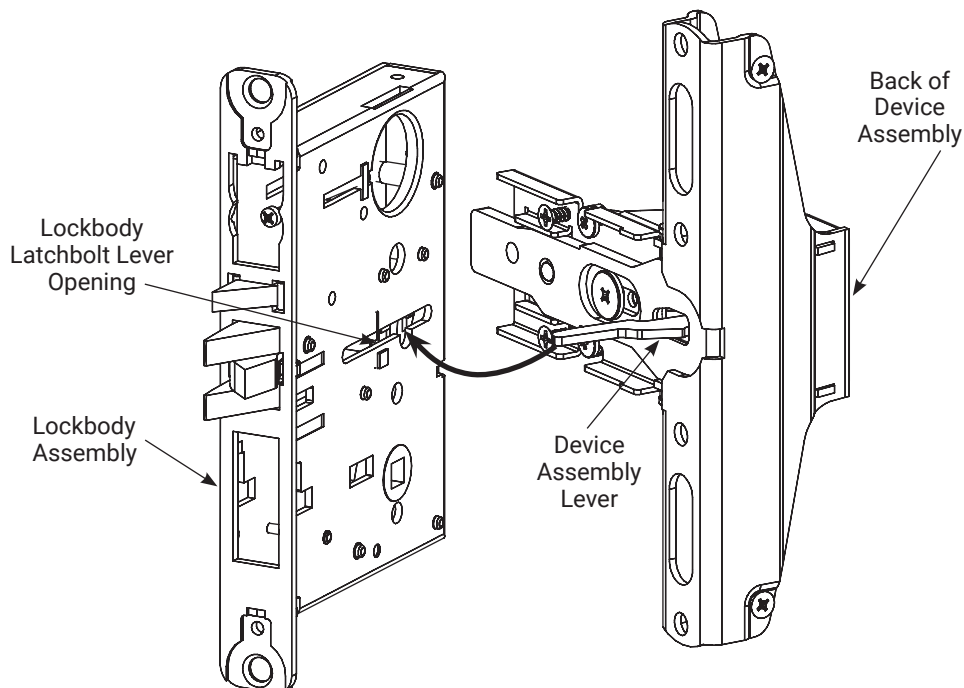

Figure 8b: Attach Device Assembly (Door not Shown)

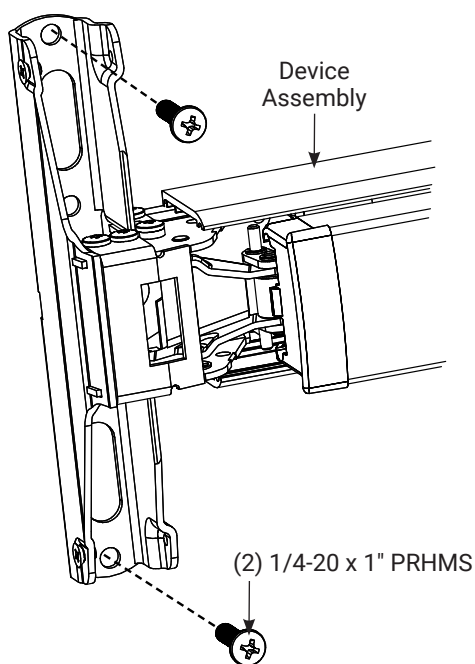
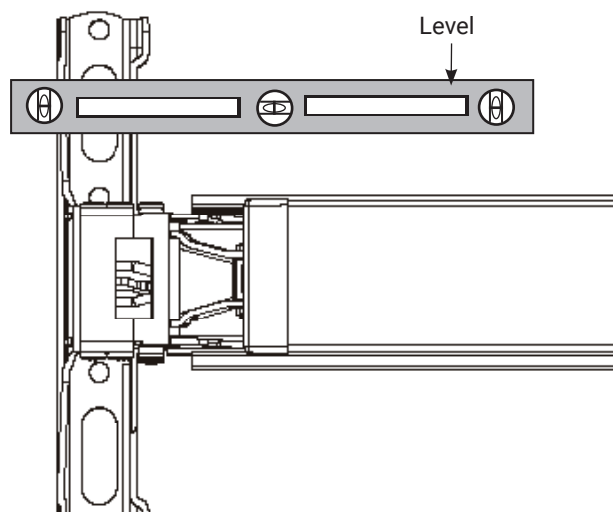

Figure 8c: Level Device Assembly



80-9460-6004-000 04/24

1-855-557-5078 Ext. 2 • www.accentra-assaabloy.com

Copyright © 2015, 2023, 2024, ASSA ABLOY ACCENTRA™ Access and Egress Hardware Group, Inc. All rights reserved. Reproduction in whole or in part without the express written permission of ASSA ABLOY Access and Egress Hardware Group, Inc. is prohibited.

Experience a safer
and more open world

K. Install Rear Clamp and End Cap

1. With device leveled, insert rear clamp, locate holes and mark (ensure rear clamp is pushed flush against device). See **Figure 9**.
2. Using the rear clamp as a template, mark and drill holes for two (2) 1/4-20 screws.
3. Install rear clamp screws and fully tighten all device and previously installed screws.
4. Slide end cap in place and secure with one (1) #10-24 x 1/2" (12.7mm) PRHMS.
5. Check latch retraction on device as follows:
 - a. Depress touch bar (latch must retract). Release touch bar (latch must extend).
 - b. Actuate trim (latch must retract). Release trim actuator (latch must extend).
 - c. While depressing touch bar, turn dogging key **CLOCKWISE**. Release touch bar (bar must remain depressed, latch must remain retracted).
 - d. While depressing touch bar, turn dogging key **COUNTERCLOCKWISE**. Release touch bar (bar and latch must return to extended position).

Figure 9: Install Rear Clamp and End Cap

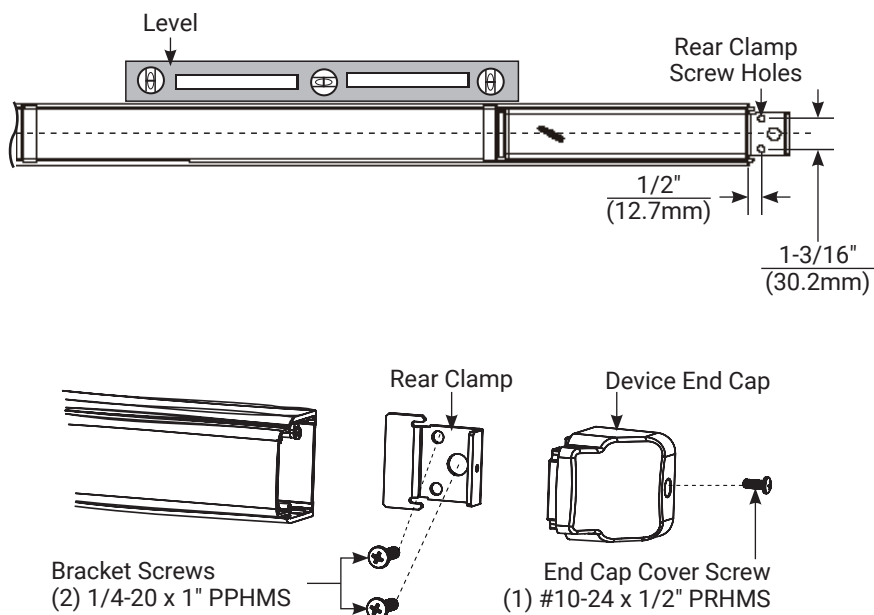

Device Assembly

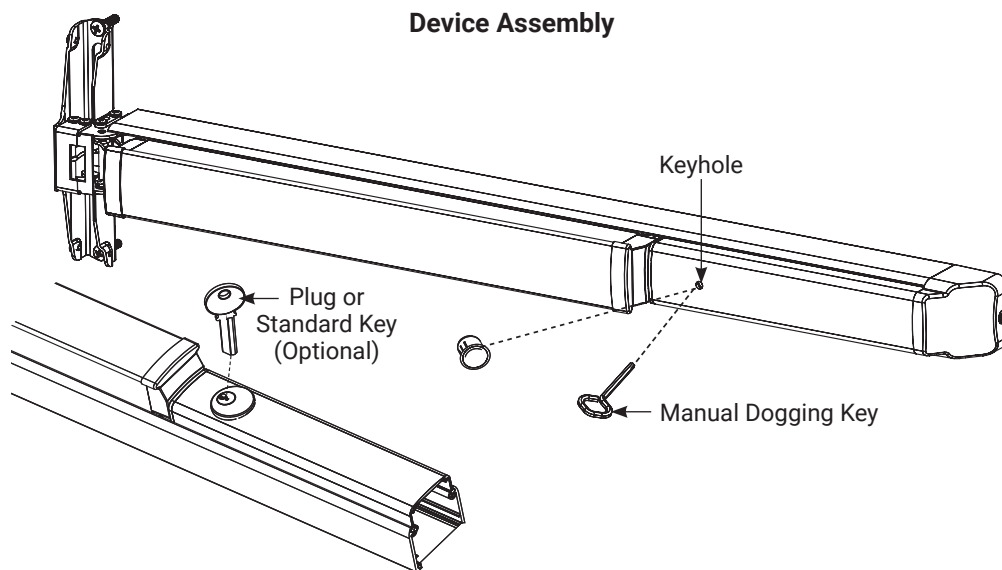

6130(F) Series

Mortise Exit Device

Installation Instructions

ACCENTRA

ASSA ABLOY

L. Device Assembly Cover Installation

1. Secure latch head cover with two (2) #8-32 x 1/4" (6.35mm) PFHUMS (**Figure 10**).
2. Install armor plate with two (2) #8-32 x 1/4" (6.35mm) PFHUMS to lockbody.

Figure 10: Device Assembly Cover Installation

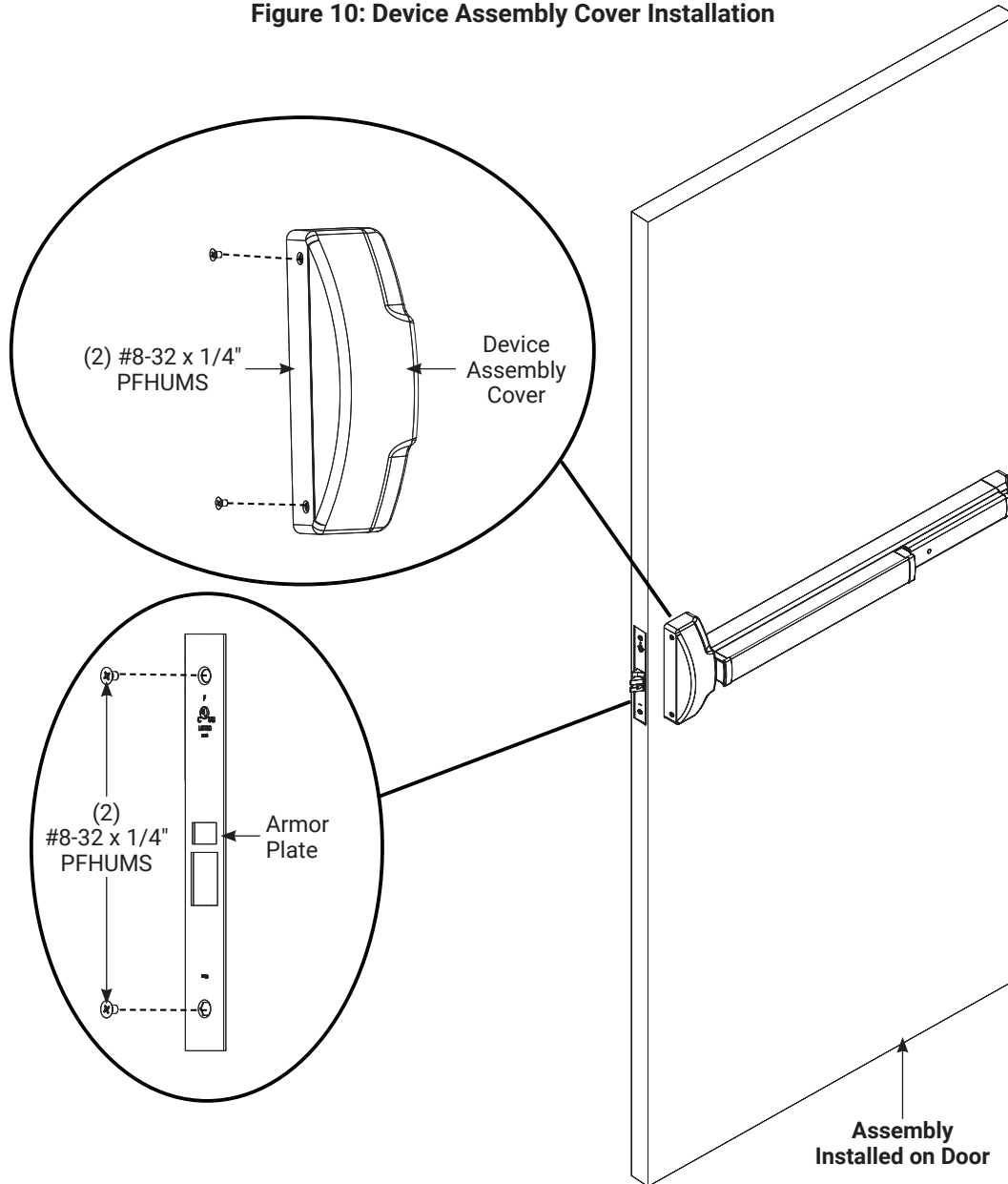

M. Operation and Maintenance

1. Finally, check and inspect operation of:
 - Trim and touch bar
 - Strike plate and bolt engagement
 - Key (optional)
2. Periodically remove covers, inspect and coat mechanisms with a silicone-based lubricant. This is required in corrosive environments for proper functionality.
3. Check mounting fasteners periodically and tighten if loose. Apply screw locking compound or change part fasteners if screws continue to back out.
4. Periodic checks (and adjustments) of strikes are required to compensate for wear-and-tear (e.g. door sagging).

Final Exit Device Assembly

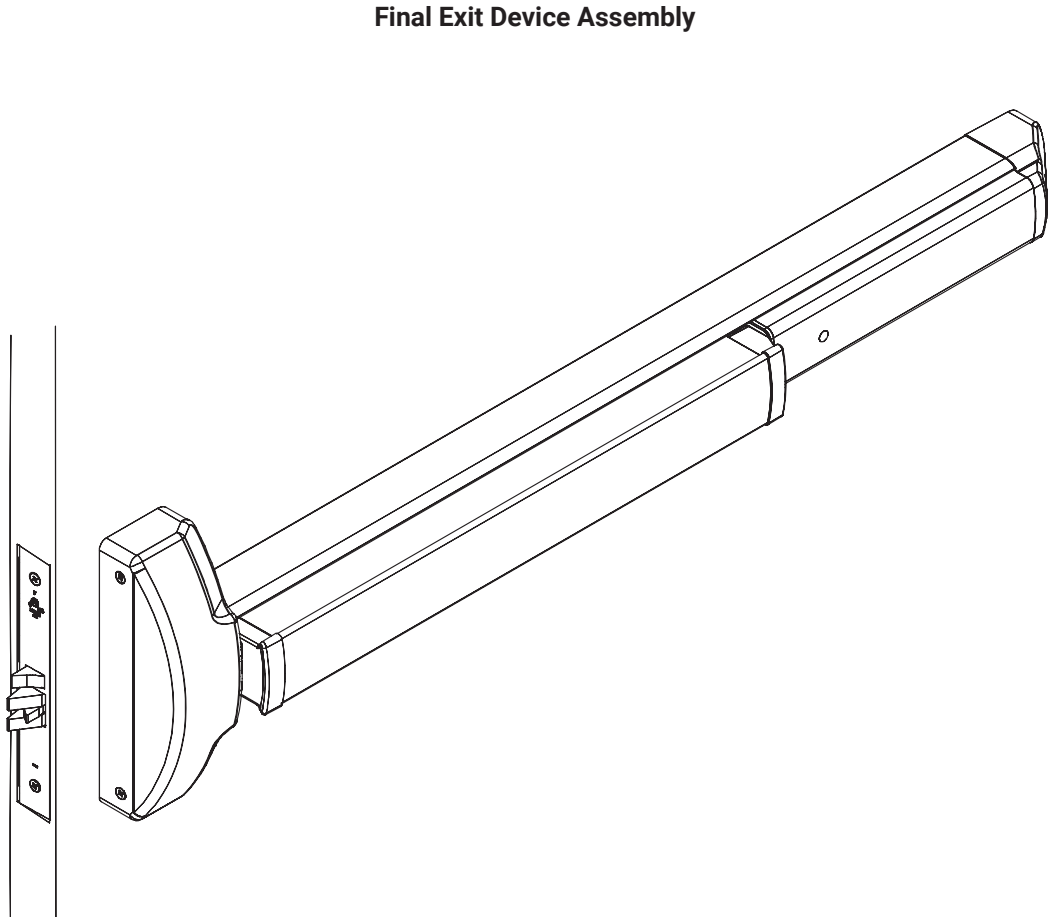

6130(F) Series
Mortise Exit Device
Installation Instructions

ACCENTRA

ASSA ABLOY

NOTES:

