

6000 Series

Shim and Anti-Pry Kits

Installation Instructions

ACCENTRA

ASSA ABLOY

For Use with All 6000 Series Exit Devices

NOTES:

- Shim kits are provided for use on all 6000 exit devices.
 - All kits are optional and are used to level the product components on the surface of the door to ensure proper closure.
1. Each standard shim kit contains two (2) sets of 1/8" thick shims.
 2. Use one (1) shim for each 1/8" (3mm) of device lift needed. When mounting the device, use longer screws provided.
 3. Before mounting the device in place on the door, position the shims behind the device assembly and the rear clamp, as shown in the instructions provided.

Tools Required

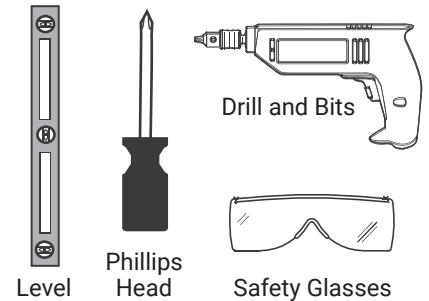

Shim Kit # 624SK
For Latch Head and
Touch Bar Bracket
WIDE (Optional)

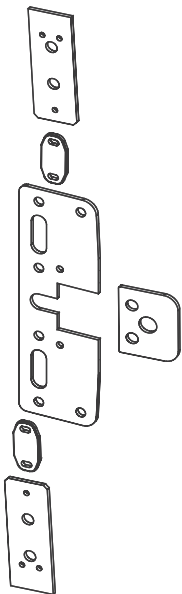

Shim Kit # 624NS
For Latch Head and
Touch Bar Bracket
NARROW (Optional)

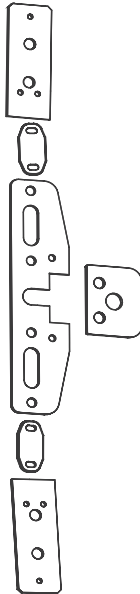

Anti-Pry Kit # 625AP
For Latch Head and
Touch Bar Bracket
(Optional)

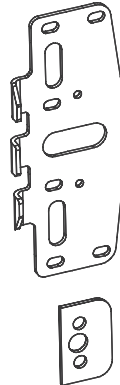

Shim Kit # 623SK
For Latch Head and
Touch Bar Bracket
WIDE (Optional)

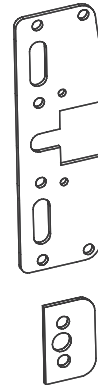

Shim Kit # 623NS
For Latch Head and
Touch Bar Bracket
NARROW (Optional)



WARNING

This product can expose you to lead which is known to the state of California to cause cancer and birth defects or other reproductive harm. For more information go to www.P65warnings.ca.gov.

WARNING

Attention Installer: Any retrofit or other field modification to a fire rated opening can potentially impact the fire rating of the opening, and ASSA ABLOY makes no representations or warranties concerning what such impact may be in any specific situation. When retrofitting any portion of an existing fire-rated opening, or specifying and installing a new fire-rated opening, please consult with a code specialist or local code official (Authority Having Jurisdiction) to ensure compliance with all applicable codes and ratings.

1-855-557-5078 Ext. 2 • www.accentra-assaabloy.com

80-9460-6008-000 04/24

Experience a safer
and more open world

Kit Numbers: 623SK, 623NS, 625AP for Rim, Mortise, and CVR Exit Devices:

Exploded View Showing Shim Placement

(Covers Removed)

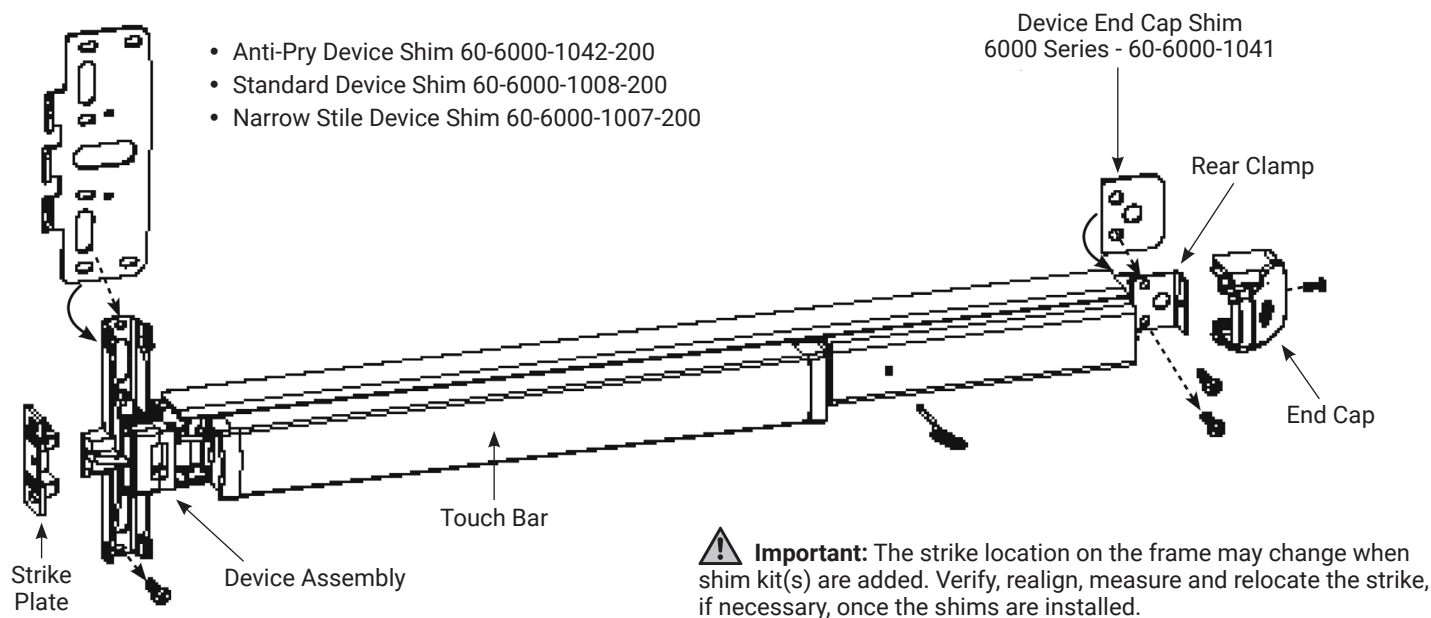

Anti-Pry Shim Location on Device

(Top View)

Anti-Pry
Device Shim

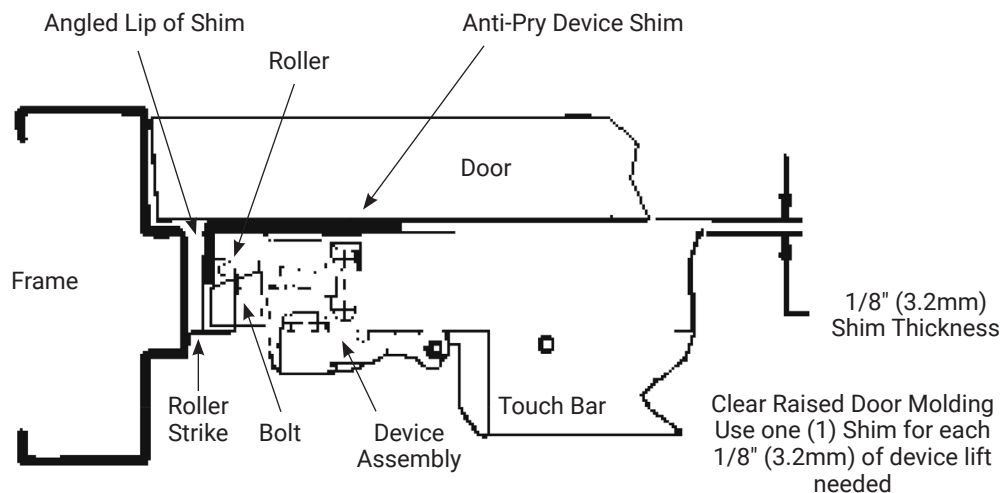
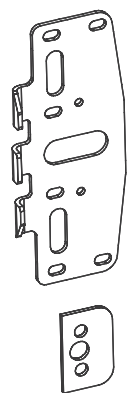

6000 Series

Shim and Anti-Pry Kits Installation Instructions

ACCENTRA

ASSA ABLOY

Shim Locations for Surface Vertical Rod Exit Devices

4. For Pullman and SquareBolt® devices, strike and shim locations will vary.
5. If installed correctly, the angled lip of the anti-pry shim will prevent access to the roller strike, located between the roller and bolt, as shown in the previous figure.

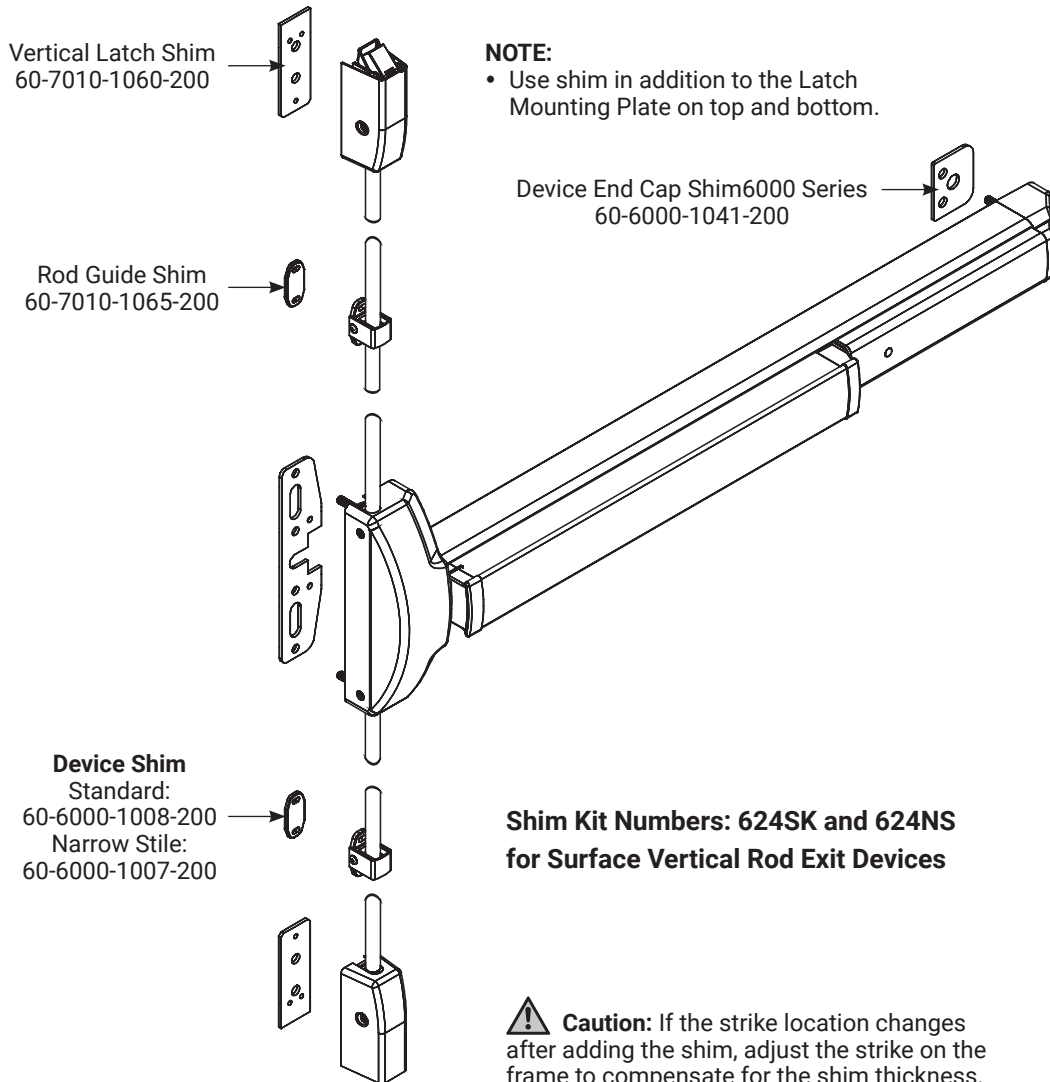

Standard Shim Location on Device
(Top View)

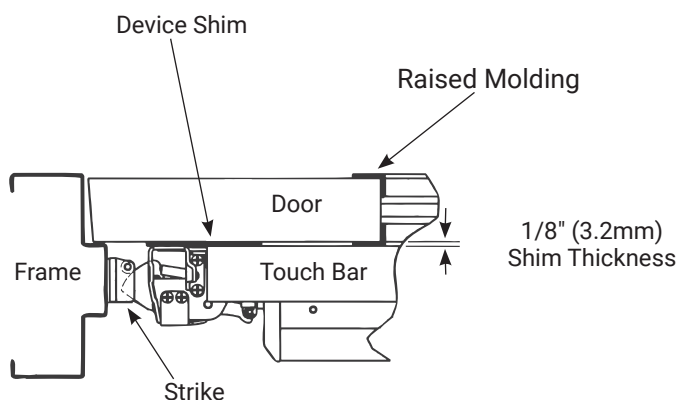

Clear Raised Door Molding
Use one (1) Shim for each
1/8" (3.2mm) of device lift needed

Yolk Pin Shim Location For Concealed
Vertical Rod Devices (Side View)

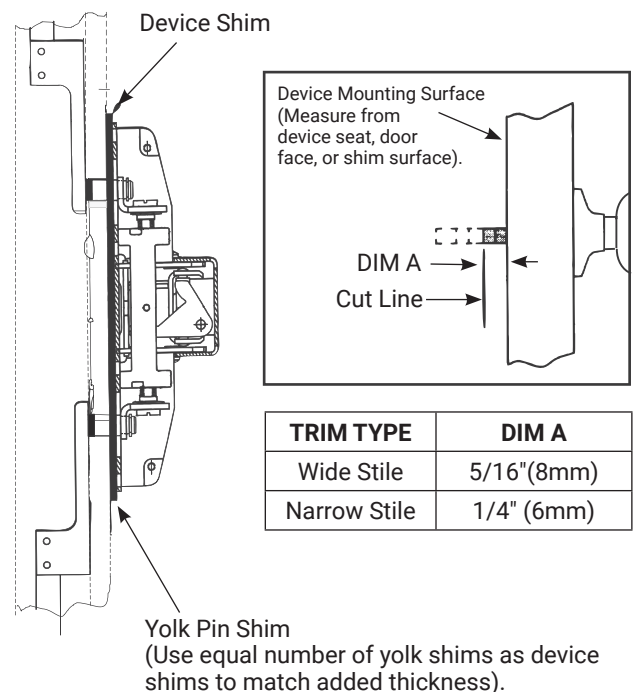

Caution: If the strike location changes after adding the shim, adjust the strike on the frame to compensate for the shim thickness.

1. For Concealed Vertical Rod Exit Device, note yoke pin shim location.
2. After all shims and device installation, check proper function and operation of trim, key, touchbar and bolt engagement.